

ACCESSORY SETUP INSTRUCTIONS

OFF-ROAD UPPER BUMPER ASSY& OFF-ROAD UPPER BUMPER ASSY_GREY PN: 6AQV-801000-6000& 6AQV-801000-6001
VALID FOR: CF400-8

BEFORE YOU BEGIN: Read and understand the instructions before starting any work. Make sure that all parts are ready and that you have all the tools required for assembly.

NOTE: CFMOTO shall not be liable for any damage caused by incorrect assembly. CFMOTO recommends that all original accessories be assembled by an authorized CFMOTO dealer.
Before assembly, park the vehicle on a flat surface and turn off the vehicle.

Zhejiang CFMOTO Power Co., Ltd. All rights reserved. Reproduction of this document, even in part, as well as copying of all kinds, is permitted only with the express written permission of the copyright owner.

MEANING OF SYMBOLS



- Indicates information with more details or tips.



- Indicates information of warning or danger.

PART LIST:

S/N	PART NAME	PART NUMBER	QTY.	DESCRIPTION
1	OFF-ROAD UPPER BUMPER ASSY& OFF-ROAD UPPER BUMPER ASSY_GREY	6AQV-801000-6000&6AQV-801000-6001	1	Picture is for structure reference only.
2	LH BUMPER&LH BUMPER_GREY	6AQV-801100-6000&6AQV-801100-6001	1	
3	RH BUMPER&RH BUMPER_GREY	6AQV-801200-6000&6AQV-801200-6001	1	
4	MOUNTING BRACKET&MOUNTING BRACKET_GREY	6AQV-801300-6000&6AQV-801300-6001	1	
5	BUSHING&BUSHING_GREY	6AQV-801001-6000&6AQV-801001-6001	2	
6	PLUG	6AQV-801002-6000	2	
7	INNER HEX SCREW M8×16	6AQV-801000-6000-20	2	
8	INNER HEX SCREW M8×25	6AQV-801000-6000-21	2	
9	INNER HEX SCREW M8×35	6AQV-801000-6000-22	2	
10	HEX FLANGE BOLT M8×16	6AQV-801000-6000-23	2	

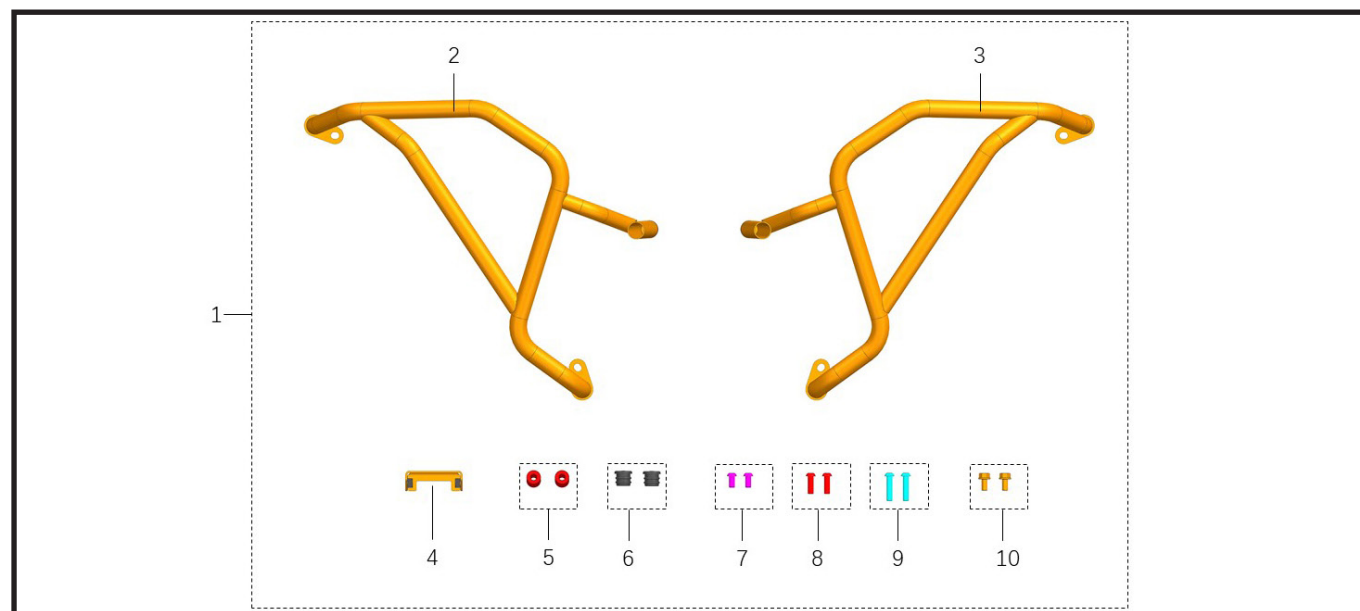

TOOL LIST:

ITEM	DESCRIPTION	REMARK
1	s=5, s=6 INNER HEX WRENCH	Recommended Tools
2	13mm SLEEVE	
3	PROTECTIVE GLOVES	

WORK

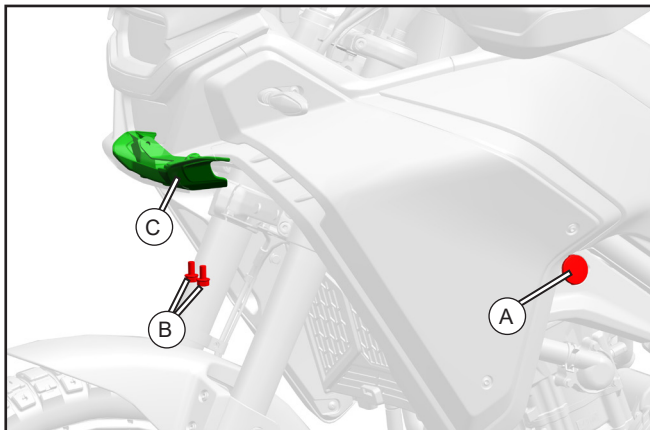

// Remove the plug (A), the screw (B), the deco cover (C) in sequence as shown.

i - The plug on right side is disassembled in the same method.

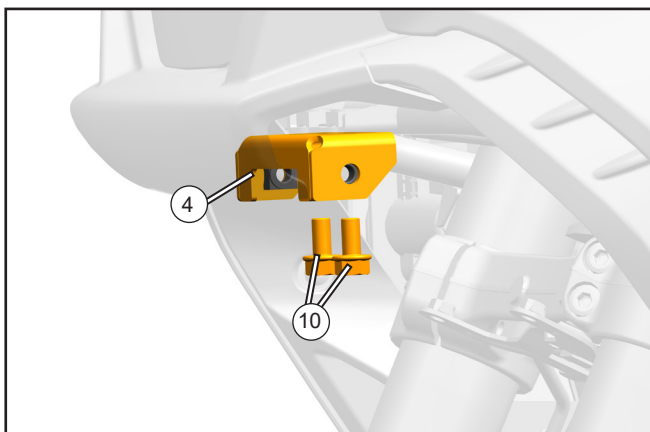

// Install the LH mounting bracket (4) on the installation position as shown, then secure it with two supplied hex flange bolts M8×16 (10).

i - The RH mounting bracket is disassembled in the same method.

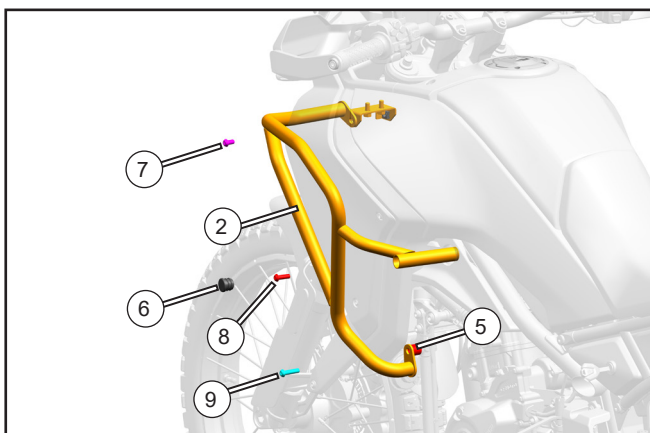

// Place the bushing (5) and LH bumper (2) on corresponding position as shown, align the installation holes.

// Secure the LH bumper with supplied inner hex screws (7,8,9), then install the plug (6).

i - The RH bumper is assembled in the same method.

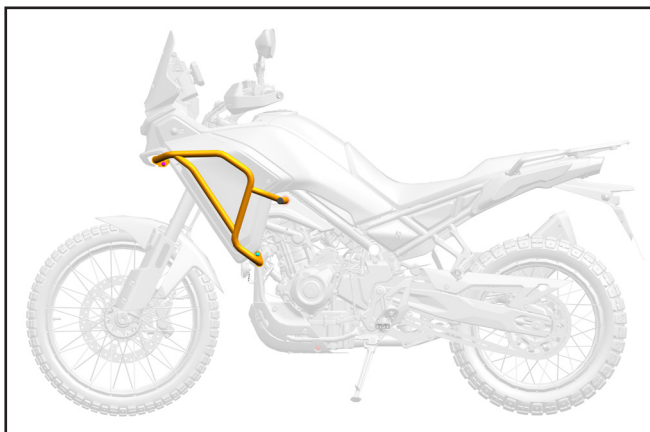

// Assembly is complete.